

direct operated solenoid valves

coil 22 mm

general information	
ambient temperature	- 10°C to + 50°C
response time	5- 8 ms
mounting	in any position
standard seal materials*	NBR, FPM, EPDM, PTFE*
dimensions	see page 2/2
coil data	see page 2/2
connector data	see page 2/2

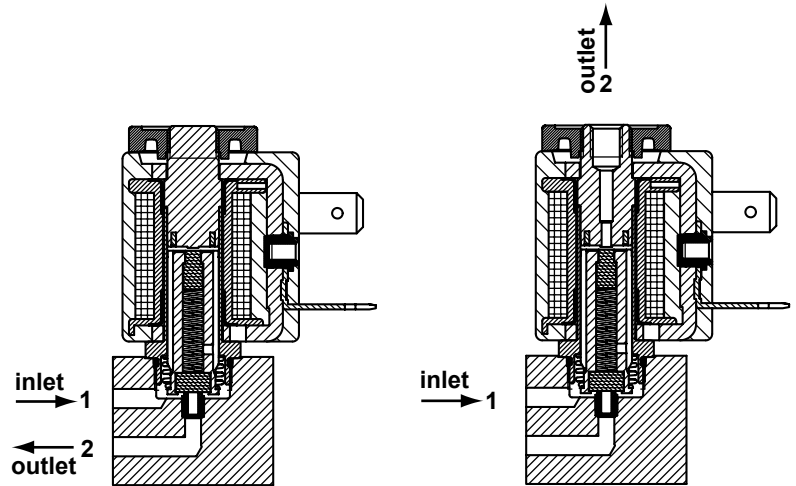

* other seal materials on request

NC

NO

function	symbol	orifice mm	*Kv	pressure range (bar)			nominal power		TABLE A main code	
				min.	max. DC	max. AC	Watt DC	V.A. AC		
								inr.		hol.
2/2 normally closed (NC) 		1.2	0.5	0	-	26	-	9	7.5	N2M112
		1.2	0.5	0	15	-	5	-	-	N2M612
		1.6	1.1	0	-	15	-	9	7.5	N2M116
		1.6	1.1	0	7.5	-	5	-	-	N2M616
2/2 normally open (NO) 		1.2	0.5	0	-	12	-	9	7.5	N2M212
		1.2	0.5	0	12	-	5	-	-	N2M712
		1.6	1.1	0	-	10	-	9	7.5	N2M216
		1.6	1.1	0	10	-	5	-	-	N2M716

*l/min. of water with ΔP of 1 bar

order code

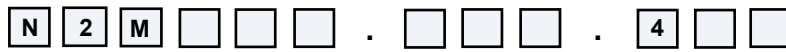

main code	stem		seals		manual override		coil code
	code	material	code	material	code	type	
see table A on this page	A	stainless AISI 303	B	NBR	0	none	see table B on page 2/2
	D	brass	V	FPM	1	brass screw	
			E	EPDM	4	plastic lever	
			T	PTFE			

direct operated solenoid valves

coil 22 mm

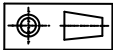
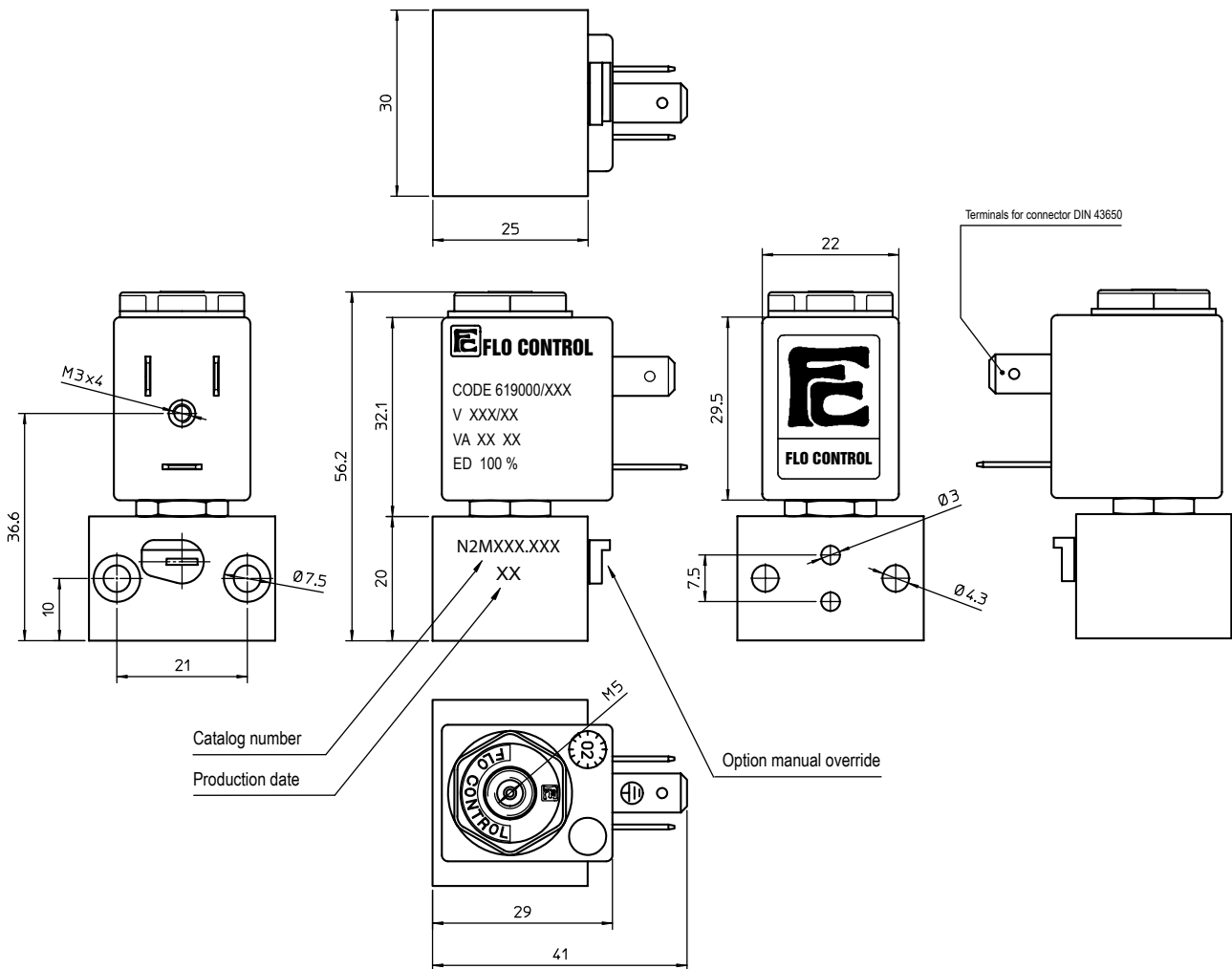

weight 115 g

coil code	TABLE B			
	*voltages	code		
		~ 50 Hz	~ 60 Hz	= DC
6	-	-	461	
12	-	-	466	
24	411	444	471	
48	416	-	476	
110	421	-	481	
115	-	453	-	
220	431	-	491	
230	457	459	-	

coil specification	
wire insulation	class H180° C
encapsulation	class F155° C
encapsulation mat.	nylon
energising duration	100% at +20° C ambient
voltage tolerance	- 10% to +15% of nominal voltage
power consumption	AC 7,5 VA - DC 5 Watt
electrical connection	DIN 43650/B (2P+ earth)
cable connection	Pg 9 (for cable dia. 6-8mm)
protection class	IP 65 (with connector)

* other voltages and wattages on request

connector (not included, must be ordered separately) code Z10030

FLO CONTROL
Solenoid Valves

 PRODUCT SERVICE	Production monitored	 IP65
	Safety tested	

